

Dimensions of Heavy Hexagon Nuts UNC and 8 UN Series

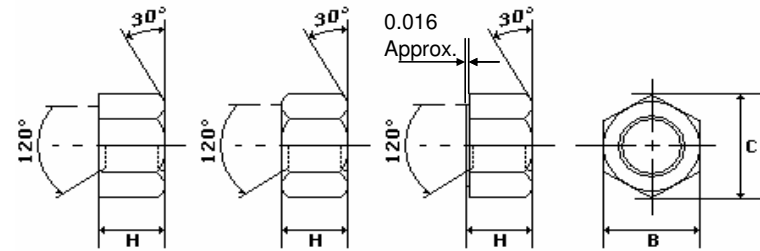

Nominal Size	Number of threads per Inch (25.4 mm.)	Width Across Flats					Width Across Corners				Thickness for Heavy Hex. Nuts					Heavy Hexagon Nuts Specified Proof Load	
		B					C				H					Up to 150,000 psi	150,000 psi and Greater
		Basic Inch	Min. Inch	Max. Inch	Min. mm.	Max. mm.	Min. Inch	Max. Inch	Min. mm.	Max. mm.	Basic Inch	Min. Inch	Max. Inch	Min. mm.	Max. mm.		
1/4"	20UNC	1/2"	0.488	0.500	12.395	12.700	0.556	0.577	14.122	14.656	15/64"	0.218	0.250	5.537	6.350	0.017	0.011
5/16"	18UNC	9/16"	0.546	0.562	13.868	14.275	0.622	0.650	15.799	16.510	19/64"	0.280	0.314	7.112	7.976	0.020	0.012
3/8"	16UNC	11/16"	0.669	0.688	16.993	17.475	0.763	0.794	19.380	20.168	23/64"	0.341	0.377	8.661	9.576	0.021	0.014
7/16"	14UNC	3/4"	0.728	0.750	18.491	19.050	0.830	0.866	21.082	21.996	27/64"	0.403	0.441	10.236	11.201	0.022	0.015
1/2"	13UNC	7/8"	0.850	0.875	21.590	22.225	0.969	1.010	24.613	25.654	31/64"	0.464	0.504	11.786	12.802	0.023	0.016
9/16"	12UNC	15/16"	0.909	0.938	23.089	23.825	1.037	1.083	26.340	27.508	35/64"	0.526	0.568	13.360	14.427	0.024	0.017
5/8"	11UNC	1.1/16"	1.031	1.062	26.187	26.975	1.175	1.227	29.845	31.166	39/64"	0.587	0.631	14.910	16.027	0.025	0.018
3/4"	10UNC	1.1/4"	1.212	1.250	30.785	31.750	1.382	1.443	35.103	36.652	47/64"	0.710	0.758	18.034	19.253	0.027	0.020
7/8"	9UNC	1.7/16"	1.394	1.438	35.408	36.525	1.589	1.660	40.361	42.164	55/64"	0.833	0.885	21.158	22.479	0.029	0.022
1"	8UNC	1.5/8"	1.575	1.625	40.005	41.275	1.796	1.876	45.618	47.650	63/64"	0.956	1.012	24.282	25.705	0.031	0.024
1.1/8"	8UN	1.13/16"	1.756	1.812	44.602	46.025	2.002	2.093	50.851	53.162	1.7/64"	1.079	1.139	27.407	28.931	0.033	0.027
1.1/4"	8UN	2"	1.938	2.000	49.225	50.800	2.209	2.309	56.109	58.649	1.7/32"	1.187	1.251	30.150	31.775	0.035	0.030
1.3/8"	8UN	2.3/16"	2.119	2.188	53.823	55.575	2.416	2.526	61.366	64.160	1.11/32"	1.310	1.378	33.274	35.001	0.038	0.033
1.1/2"	8UN	2.3/8"	2.300	2.375	58.420	60.325	2.622	2.742	66.599	69.647	1.15/32"	1.433	1.505	36.398	38.227	0.041	0.036
1.5/8"	8UN	2.9/16"	2.481	2.562	63.017	65.075	2.828	2.959	71.831	75.159	1.19/32"	1.556	1.632	39.522	41.453	0.044	0.038
1.3/4"	8UN	2.3/4"	2.662	2.750	67.615	69.850	3.035	3.175	77.089	80.645	1.23/32"	1.679	1.759	42.647	44.679	0.048	0.041
1.7/8"	8UN	2.15/16"	2.844	2.938	72.238	74.625	3.242	3.392	82.347	86.157	1.27/32"	1.802	1.886	45.771	47.904	0.051	0.044
2"	8UN	3.1/8"	3.025	3.125	76.835	79.375	3.449	3.608	87.605	91.643	1.31/32"	1.925	2.013	48.895	51.130	0.055	0.047
2.1/4"	8UN	3.1/2"	3.388	3.500	86.055	88.900	3.862	4.041	98.095	102.641	2.13/64"	2.155	2.251	54.737	57.175	0.061	0.052
2.1/2"	8UN	3.7/8"	3.750	3.875	95.250	98.425	4.275	4.474	108.585	113.640	2.29/64"	2.401	2.505	60.985	63.627	0.068	0.058
2.3/4"	8UN	4.1/4"	4.112	4.250	104.445	107.950	4.688	4.097	119.075	124.064	2.45/64"	2.647	2.759	67.234	70.079	0.074	0.064
3"	8UN	4.5/8"	4.475	4.625	113.665	117.475	5.102	5.340	129.591	135.636	2.61/64"	2.893	3.013	73.482	76.530	0.081	0.070
3.1/4"	8UN	5"	4.838	5.000	122.885	127.000	5.515	5.774	140.081	146.660	3.3/16"	3.124	3.252	79.350	82.601	0.087	0.075
3.1/2"	8UN	5.3/8"	5.200	5.375	132.080	136.525	5.928	6.207	150.571	157.658	3.7/16"	3.370	3.506	85.598	89.052	0.091	0.081
3.3/4"	8UN	5.3/4"	5.562	5.750	141.275	146.050	6.341	6.640	161.061	168.656	3.11/16"	3.616	3.760	91.846	95.504	0.100	0.087
4"	8UN	6"	5.925	6.125	150.495	155.575	6.755	7.073	171.577	179.654	3.15/16"	3.862	4.014	98.095	101.956	0.107	0.093

Notes :- Width across flats and corners, as well as thickness are to American Standard B 18.2.2 "Heavy semi-finished Hexagon Nut"
Threading according to ANSI B1.1 UNC 1982 up to 1", 8 Threads UN from diameter 1.1/8".